

Precision ER Collets, Power Coat Nuts, Other Collets

Full Line of ER Collets

Made from high-carbon bearing steel and heat treated for improved flexibility and longer life.



ER Inch Sizes



Sealed Coolant



Steel Sealed Coolant



ER Metric Sizes



Quick-Change Tap Collet



Floating Tap Collet



Rigid Tap Collet

Power Coat Nut

Points of Friction



threads

shoulder



Balanced up to to 70,000 RPMs

Our special Power Coat nut reduces friction so it can increase holding power by 75% compared to standard nuts. Holding power increases cutting tool life.

Other Collet Styles



DNA Dead Nuts
Accurate ER



TG 75, TG 100,
TG 150



SYOZ / EOC
Perske



DA Double
Angle

You lose 10% of tool life for every .0001" of T.I.R.
The holding power and accuracy of Techniks collets
and Power Coat nuts extend cutting tool life.

**We don't sell tools.
We sell tool life.**

I guarantee your satisfaction with every Techniks product.

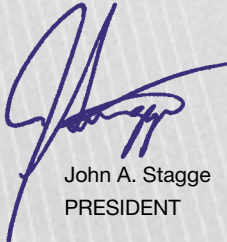

John A. Stagge
PRESIDENT

Inch Size Precision ER Collets and Collet Sets

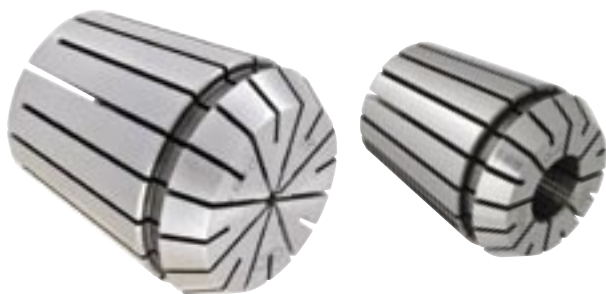

Standard Inch Size ER Collet Features

- Average .0002" T.I.R.
- Clamping range: .039"
- Use with Power Coat nut (pg. 50) for best holding power and cutting tool life.

Compatible with DR, RD, ESX, AR, & BR series collets.



Ultra Precision Collets

- .0002" T.I.R. or better
- Put UP in front of part number

ER Inch Size Collet Sets

Part No.	Size	Pieces	Collets Included	Fits Shank Sizes
04208IS	ER 11	7	1/16 - 1/4" by 32 ^{nds}	1/32 - 1/4"
04209IS	ER 16	10	3/32 - 3/8" by 32 ^{nds}	1/16 - 3/8"
04210IS	ER 20	12	5/32 - 1/2" by 32 ^{nds}	1/8 - 1/2"
04211IS	ER 25	16	5/32 - 5/8" by 32 ^{nds}	1/8 - 5/8"
04212IS	ER 32	18	7/32 - 3/4" by 32 ^{nds}	3/16 - 3/4"
04213IS	ER 40	13	1/8 - 1.0" by 16 ^{ths}	1/8 - 1.0"

ER 8 Inch Size Collets

Part No.	Inch Range	Shank
04208-1/16	.043 - .062"	1/16"
04208-1/8	.086 - .125"	1/8"
04208-3/16	.148 - .187"	3/16"

ER 11 Inch Size Collets

Part No.	Inch Range	Shank
04211-1/16	.043 - .062"	1/16"
04211-3/32	.054 - .093"	3/32"
04211-1/8	.086 - .125"	1/8"
04211-5/32	.117 - .156"	5/32"
04211-3/16	.148 - .187"	3/16"
04211-7/32	.179 - .218"	7/32"
04211-1/4	.211 - .250"	1/4"
04211-9/32	-	9/32"

ER 16 Inch Size Collets

Part No.	Inch Range	Shank
04216-1/16	.043 - .062"	1/16"
04216-3/32	.054 - .093"	3/32"
04216-1/8	.086 - .125"	1/8"
04216-5/32	.117 - .156"	5/32"
04216-3/16	.148 - .187"	3/16"
04216-7/32	.179 - .218"	7/32"
04216-1/4	.211 - .250"	1/4"
04216-9/32	.242 - .281"	9/32"
04216-5/16	.273 - .312"	5/16"
04216-11/32	.304 - .343"	11/32"
04216-3/8	.336 - .375"	3/8"
04216-13/32	.367 - .406"	13/32"

ER 20 Inch Size Collets

Part No.	Inch Range	Shank
04220-1/16	.043 - .062"	1/16"
04220-3/32	.054 - .093"	3/32"
04220-1/8	.086 - .125"	1/8"
04220-5/32	.117 - .156"	5/32"
04220-3/16	.148 - .187"	3/16"
04220-7/32	.179 - .218"	7/32"
04220-1/4	.211 - .250"	1/4"
04220-9/32	.242 - .281"	9/32"
04220-5/16	.273 - .312"	5/16"
04220-11/32	.304 - .343"	11/32"
04220-3/8	.336 - .375"	3/8"
04220-13/32	.367 - .406"	13/32"
04220-7/16	.398 - .437"	7/16"
04220-15/32	.429 - .468"	15/32"
04220-1/2	.461 - .500"	1/2"

Inch Size Precision ER Collets

ER 25 Inch Size Collets

Part No.	Inch Range	Shank
04225-3/32	.054 - .093"	3/32"
04225-1/8	.086 - .125"	1/8"
04225-5/32	.117 - .156"	5/32"
04225-3/16	.148 - .187"	3/16"
04225-7/32	.179 - .218"	7/32"
04225-1/4	.211 - .250"	1/4"
04225-9/32	.242 - .281"	9/32"
04225-5/16	.273 - .312"	5/16"
04225-11/32	.304 - .343"	11/32"
04225-3/8	.336 - .375"	3/8"
04225-13/32	.367 - .406"	13/32"
04225-7/16	.398 - .437"	7/16"
04225-15/32	.429 - .468"	15/32"
04225-1/2	.461 - .500"	1/2"
04225-17/32	.492 - .531"	17/32"
04225-9/16	.523 - .562"	9/16"
04225-19/32	.554 - .593"	19/32"
04225-5/8	.586 - .625"	5/8"
04225-3/4	.711 - .750"	3/4"

ER 32 Inch Size Collets

Part No.	Inch Range	Shank
04232-1/16	.043 - .062"	1/16"
04232-3/32	.054 - .093"	3/32"
04232-1/8	.086 - .125"	1/8"
04232-5/32	.117 - .156"	5/32"
04232-3/16	.148 - .187"	3/16"
04232-7/32	.179 - .218"	7/32"
04232-1/4	.211 - .250"	1/4"
04232-9/32	.242 - .281"	9/32"
04232-5/16	.273 - .312"	5/16"
04232-11/32	.304 - .343"	11/32"
04232-3/8	.336 - .375"	3/8"
04232-13/32	.367 - .406"	13/32"
04232-7/16	.398 - .437"	7/16"
04232-15/32	.429 - .468"	15/32"
04232-1/2	.461 - .500"	1/2"
04232-17/32	.492 - .531"	17/32"
04232-9/16	.523 - .562"	9/16"
04232-19/32	.554 - .593"	19/32"
04232-5/8	.586 - .625"	5/8"
04232-21/32	.617 - .656"	21/32"
04232-11/16	.648 - .687"	11/16"
04232-23/32	.679 - .718"	23/32"
04232-3/4	.711 - .750"	3/4"

ER 40 Inch Size Collets

Part No.	Inch Range	Shank
04240-1/8	.086 - .125"	1/8"
04240-5/32	.117 - .156"	5/32"
04240-3/16	.148 - .187"	3/16"
04240-7/32	.179 - .218"	7/32"
04240-1/4	.211 - .250"	1/4"
04240-9/32	.242 - .281"	9/32"
04240-5/16	.273 - .312"	5/16"
04240-11/32	.304 - .343"	11/32"
04240-3/8	.336 - .375"	3/8"
04240-13/32	.367 - .406"	13/32"
04240-7/16	.398 - .437"	7/16"
04240-15/32	.429 - .468"	15/32"
04240-1/2	.461 - .500"	1/2"
04240-17/32	.492 - .531"	17/32"
04240-9/16	.523 - .562"	9/16"
04240-19/32	.554 - .593"	19/32"
04240-5/8	.586 - .625"	5/8"
04240-21/32	.617 - .656"	21/32"
04240-11/16	.648 - .687"	11/16"
04240-23/32	.679 - .718"	23/32"
04240-3/4	.711 - .750"	3/4"
04240-25/32	.742 - .781"	25/32"
04240-13/16	.773 - .812"	13/16"
04240-27/32	.807 - .843"	27/32"
04240-7/8	.836 - .875"	7/8"
04240-29/32	.867 - .906"	29/32"
04240-15/16	.898 - .937"	15/16"
04240-31/32	.929 - .968"	31/32"
04240-1	.961 - 1.00"	1.0"

Use the table (below) for selecting your replacement collets. ER collets all have unique length and diameter measurements.

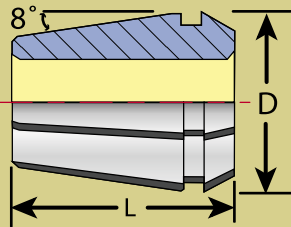

ER Size	L	D
ER 8	13mm (.51")	8.5mm (.33")
ER 11	18mm (.708")	11.5mm (.45")
ER 16	27.5mm (1.08")	17mm (.67")
ER 20	31.5mm (1.24")	21mm (.83")
ER 25	34mm (1.34")	26mm (1.02")
ER 32	40mm (1.57")	33mm (1.3")
ER 40	46mm (1.81")	41mm (1.61")
ER 50	60 mm (2.36")	52mm (2.05")

ER 50 Inch Size Collets

Part No.	Inch Range	Shank
04250-1/2	.461 - .500"	1/2"
04250-5/8	.586 - .625"	5/8"
04250-3/4	.711 - .750"	3/4"
04250-7/8	.836 - .875"	7/8"
04250-1	.961 - 1.00"	1.0"
04250-1-1/4	1.211 - 1.250"	1-1/4"

Metric Size Precision ER Collets and Collet Sets

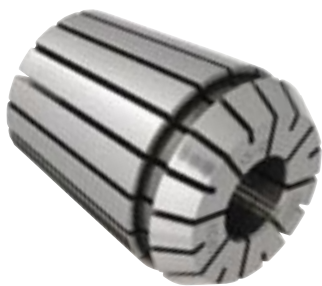

Compatible with DR, RD, ESX, AR, & BR series collets.

To Order Ultra Precision Collets

Hand-selected Ultra Precision collets are guaranteed .0002" T.I.R. or better. Just place UP in front of the regular part number when ordering.



ER Metric Collet Sets

Part No.	Size	Pieces	Collets Included	Fits Shank Sizes
04200MS	ER 8	9	1 - 5mm by 0.5mm	.5 - 5mm
04201MS	ER 11	13	1 - 7mm by 0.5mm	.5 - 7mm
04202MS	ER 16	10	1 - 10mm by 1mm	.5 - 10mm
04203MS	ER 20	12	2 - 13mm by 1mm	1.0 - 13mm
04204MS	ER 25	15	2 - 16mm by 1mm	1.0 - 16mm
04205MS	ER 32	18	3 - 20mm by 1mm	2 - 20mm
04206MS	ER 40	23	4 - 26mm by 1mm	3 - 26mm
04207MS	ER 50	17	6 - 34mm by 2 mm	5 - 34mm

Metric ER Precision Collet Features

- Average .0002" T.I.R.
- Clamping range: .039"
- Use with Power Coat nut (pg. 50) for best holding power and cutting tool life.

ER 8 Precision Metric Collets

Part No.	Inch Range	Shank
04208-01.0	.019 - .039"	0.5 - 1.0
04208-01.5	.039 - .059"	1.0 - 1.5
04208-02.0	.059 - .079"	1.5 - 2.0
04208-02.5	.079 - .098"	2.0 - 2.5
04208-03.0	.098 - .118"	2.5 - 3.0
04208-03.5	.118 - .138"	3.0 - 3.5
04208-04.0	.138 - .157"	3.5 - 4.0
04208-04.5	.157 - .177"	4.0 - 4.5
04208-05.0	.177 - .197"	4.5 - 5.0

ER 11 Precision Metric Collets

Part No.	Inch Range	Shank
04211-01.0	.019 - .039"	0.5 - 1.0
04211-01.5	.039 - .059"	1.0 - 1.5
04211-02.0	.059 - .079"	1.5 - 2.0
04211-02.5	.079 - .098"	2.0 - 2.5
04211-03.0	.098 - .118"	2.5 - 3.0
04211-03.5	.118 - .138"	3.0 - 3.5
04211-04.0	.138 - .157"	3.5 - 4.0
04211-04.5	.157 - .177"	4.0 - 4.5
04211-05.0	.177 - .197"	4.5 - 5.0
04211-05.5	.197 - .217"	5.0 - 5.5
04211-06.0	.217 - .236"	5.5 - 6.0
04211-06.5	.236 - .256"	6.0 - 6.5
04211-07.0	.256 - .276"	6.5 - 7.0

ER 16 Precision Metric Collets

Part No.	Inch Range	Shank
04216-01	.019 - .039"	0.5-1
04216-01.5	.039 - .059"	1.0-1.5
04216-02	.039 - .079"	1-2
04216-02.5	.059 - .098"	1.5-2.5
04216-03	.079 - .118"	2-3
04216-03.5	.098 - .137"	2.5-3.5
04216-04	.118 - .157"	3-4
04216-04.5	.137 - .177"	3.5-4.5
04216-05	.157 - .197"	4-5
04216-05.5	.177 - .216"	4.5-5.5
04216-06	.197 - .236"	5-6
04216-06.5	.216 - .255"	5.5-6.5
04216-07	.236 - .276"	6-7
04216-07.5	.255 - .295"	6.5-7.5
04216-08	.276 - .315"	7-8
04216-08.5	.295 - .334"	7.5-8.5
04216-09	.315 - .354"	8-9
04216-09.5	.334 - .374"	8.5-9.5
04216-10	.354 - .394"	9-10
04216-10.5	.374 - .413"	9.5-10.5

ER 20 Precision Metric Collets

Part No.	Inch Range	Shank
04220-01	.019 - .039"	0.5-1
04220-01.5	.039 - .059"	1.0-1.5
04220-02	.039 - .079"	1-2
04220-02.5	.059 - .098"	1.5-2.5
04220-03	.079 - .118"	2-3
04220-03.5	.098 - .137"	2.5-3.5
04220-04	.118 - .157"	3-4
04220-04.5	.137 - .177"	3.5-4.5
04220-05	.157 - .197"	4-5
04220-05.5	.177 - .216"	4.5-5.5
04220-06	.197 - .236"	5-6
04220-06.5	.216 - .255"	5.5-6.5
04220-07	.236 - .276"	6-7
04220-07.5	.255 - .295"	6.5-7.5
04220-08	.276 - .315"	7-8
04220-08.5	.295 - .334"	7.5-8.5
04220-09	.315 - .354"	8-9
04220-09.5	.334 - .374"	8.5-9.5
04220-10	.354 - .394"	9-10
04220-10.5	.374 - .413"	9.5-10.5
04220-11	.394 - .433"	10-11
04220-11.5	.413 - .452"	10.5-11.5
04220-12	.433 - .472"	11-12
04220-12.5	.452" - .492"	11.5-12.5
04220-13	.472 - .512"	12-13
04220-13.5	.492 - .531"	12.5-13.5
04220-14	.512 - .551"	13-14

Metric Size Precision ER Collets

ER 25 Precision Metric Collets

Part No.	Inch Range	Shank mm
04225-02	.039 - .079"	1-2
04225-02.5	.059 - .098"	1.5-2.5
04225-03	.079 - .118"	2-3
04225-03.5	.098 - .137"	2.5-3.5
04225-04	.118 - .157"	3-4
04225-05	.157 - .197"	4-5
04225-06	.197 - .236"	5-6
04225-07	.236 - .276"	6-7
04225-08	.276 - .315"	7-8
04225-09	.315 - .354"	8-9
04225-10	.354 - .394"	9-10
04225-11	.394 - .433"	10-11
04225-12	.433 - .472"	11-12
04225-13	.472 - .512"	12-13
04225-14	.512 - .551"	13-14
04225-15	.551 - .591"	14-15
04225-16	.591 - .630"	15-16
04225-17	.630 - .669"	16-17

Use the table (below) for selecting your replacement collets. ER collets all have unique length and diameter measurements.

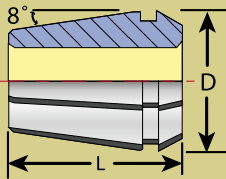

ER Size	L	D
ER 8	13mm (.51")	8.5mm (.33")
ER 11	18mm (0.708")	11.5mm (0.45")
ER 16	27.5mm (1.08")	17mm (0.67")
ER 20	31.5mm (1.24")	21mm (0.83")
ER 25	34mm (1.34")	26mm (1.02")
ER 32	40mm (1.57")	33mm (1.3")
ER 40	46mm (1.81")	41mm (1.61")
ER 50	60 mm (2.36")	52mm (2.05")

ER 32 Precision Metric Collets

Part No.	Inch Range	Shank mm
04232-03	.079 - .118"	2-3
04232-03.5	.098 - .137"	2.5-3.5
04232-04	.118 - .157"	3-4
04232-04.5	.137 - .177"	3.5-4.5
04232-05	.157 - .197"	4-5
04232-05.5	.177 - .216"	4.5-5.5
04232-06	.197 - .236"	5-6
04232-06.5	.216 - .255"	5.5-6.5
04232-07	.236 - .276"	6-7
04232-07.5	.255 - .295"	6.5-7.5
04232-08	.276 - .315"	7-8
04232-08.5	.295 - .334"	7.5-8.5
04232-09	.315 - .354"	8-9
04232-09.5	.334 - .374"	8.5-9.5
04232-10	.354 - .394"	9-10
04232-10.5	.374 - .413"	9.5-10.5
04232-11	.394 - .433"	10-11
04232-11.5	.413 - .452"	10.5-11.5
04232-12	.433 - .472"	11-12
04232-12.5	.452 - .492"	11.5-12.5
04232-13	.472 - .512"	12-13
04232-13.5	.492 - .531"	12.5-13.5
04232-14	.512 - .551"	13-14
04232-14.5	.531 - .570"	13.5-14.5
04232-15	.551 - .591"	14-15
04232-15.5	.570 - .610"	14.5-15.5
04232-16	.591 - .630"	15-16
04232-16.5	.610 - .649"	15.5-16.5
04232-17	.630 - .669"	16-17
04232-17.5	.649 - .688"	16.5-17.5
04232-18	.669 - .709"	17-18
04232-18.5	.688 - .728"	17.5-18.5
04232-19	.709 - .748"	18-19
04232-19.5	.728 - .767"	18.5-19.5
04232-20	.748 - .787"	19-20
04232-21	.787 - .827"	20-21

ER 40 Precision Metric Collets

Part No.	Inch Range	Shank mm
04240-04	.118 - .157"	3-4
04240-05	.157 - .197"	4-5
04240-06	.197 - .236"	5-6
04240-07	.236 - .276"	6-7
04240-08	.276 - .315"	7-8
04240-09	.315 - .354"	8-9
04240-10	.354 - .394"	9-10
04240-11	.394 - .433"	10-11
04240-12	.433 - .472"	11-12
04240-13	.472 - .512"	12-13
04240-14	.512 - .551"	13-14
04240-15	.551 - .591"	14-15
04240-16	.591 - .630"	15-16
04240-17	.630 - .669"	16-17
04240-18	.669 - .709"	17-18
04240-19	.709 - .748"	18-19
04240-20	.748 - .787"	19-20
04240-21	.787 - .827"	20-21
04240-22	.827 - .866"	21-22
04240-23	.866 - .906"	22-23
04240-24	.906 - .945"	23-24
04240-25	.945 - .984"	24-25
04240-26	.984 - 1.024"	25-26

ER 50 Precision Metric Collets

Part No.	Inch Range	Shank mm
04250-06	.197 - .236"	5-6
04250-07	.236 - .276"	6-7
04250-08	.276 - .315"	7-8
04250-09	.315 - .354"	8-9
04250-10	.354 - .394"	9-10
04250-12	.394 - .472"	10-12
04250-14	.472 - .551"	12-14
04250-16	.551 - .630"	14-16
04250-18	.630 - .709"	16-18
04250-20	.709 - .787"	18-20
04250-22	.787 - .866"	20-22
04250-24	.866 - .945"	22-24
04250-26	.945 - 1.024"	24-26
04250-28	1.024 - 1.102"	26-28
04250-30	1.102 - 1.181"	28-30
04250-32	1.181 - 1.259"	30-32
04250-34	1.259 - 1.338"	32-34

DNA – Dead Nuts Accurate Collets For Small Size Tools

DNA Collets Features

- .0002" T.I.R. extends cutting tool life!
- Best collet for tools 1/8" (6mm) and smaller
- More rigid and more accurate than ER, but works with your ER holders

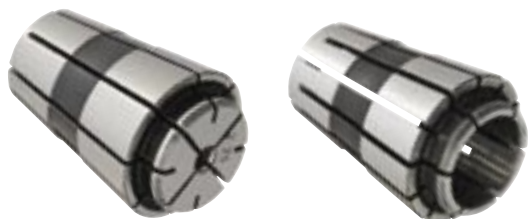

DNA 11 Dead Nuts Accurate Collets

Part No.	Shank Size inch/mm	Range inch /mm
1111.0300	7/64" / 2.5 - 3mm	.098" - .118" / .5mm
1111.0350	1/8" / 3 - 3.5mm	.118" - .138" / .5mm
1111.0400	5/32" / 3.5 - 4mm	.138" - .157" / .5mm
1111.0500	3/16" / 4.5 - 5mm	.177" - .197" / .5mm
1111.0600	15/64" / 5.5 - 6mm	.216" - .236" / .5mm
1111.0018	exact size collet: 1/8"	.105" - .125" / .5mm
1111.0316	exact size collet: 3/16"	.167" - .187" / .5mm
1111.0014	exact size collet: 1/4"	.230" - .250" / .5mm
2011.0000	DNA 11 nut M14 x .75"	
2011.0000C	DNA 11 coolant nut for 1/8" and 3mm	
DNA11W	DNA 11 collet wrench	
DNA11TWA	DNA 11 torque wrench adapter	

ER Collet **DNA Collet**

DNA collets hold small tools with greater rigidity and more accuracy (T.I.R.) for greatly improved tool life.

DNA 16 Dead Nuts Accurate Collets

Part No.	Shank Size inch/mm	Range inch/mm
1016.0030	.2 - .3mm	.007" - .011" / .10mm
1016.0040	1/64" / .3 - .4mm	.011" - .015" / .10mm
1016.0050	.4 - .5mm	.015" - .019" / .10mm
1016.0060	.5 - .6mm	.019" - .023" / .10mm
1016.0080	1/32" / .7 - .8mm	.027" - .031" / .10mm
1016.0100	.9 - 1.0mm	.035" - .039" / .10mm
1016.0120	3/64" / 1.1 - 1.2mm	.043" - .047" / .10mm
1116.0125	1.0 - 1.25mm	.039" - .049" / .25mm
1116.0150	1.25 - 1.5mm	.049" - .059" / .25mm
1116.0175	1/16" / 1.5 - 1.75mm	.059" - .068" / .25mm
1116.0200	5/64" / 1.75 - 2mm	.068" - .078" / .25mm
1116.0225	2 - 2.25mm	.078" - .088" / .25mm
1116.0250	3/32" / 2.25 - 2.5mm	.088" - .098" / .25mm
1116.0300	2.5 - 3mm	.098" - .118" / .5mm
1116.0350	1/8" / 3 - 3.5mm	.118" - .138" / .5mm
1116.0400	5/32" / 3.5 - 4mm	.137" - .157" / .5mm
1116.0450	4 - 4.5mm	.157" - .177" / .5mm
1116.0500	3/16" / 4 - 5mm	.157" - .197" / .25mm
1116.0600	7/32" / 5 - 6mm	.196" - .236" / 1.0mm
1116.0700	1/4" / 6 - 7mm	.236" - .275" / 1.0mm
1116.0800	5/16" / 7 - 8mm	.275" - .314" / 1.0mm
1116.0900	11/32" / 8 - 9mm	.314" - .354" / 1.0mm
1116.1000	3/8" / 9 - 10mm	.354" - .392" / 1.0mm
1116.0018	exact size collet: 1/8"	.105" - .125" / .5mm
1116.0316	exact size collet: 3/16"	.147" - .187" / 1.0mm
1116.0014	exact size collet: 1/4"	.210" - .25" / 1.0mm
1116.0038	exact size collet: 3/8"	.335" - .375" / 1.0mm

DNA – Dead Nuts Accurate Collets For Small Size Tools



DNA 16 Nuts, Sealed Nuts, Wrenches and TWA's

Part No.	Description
2016-2000	DNA16 Mini Nut - M19 x 1.0" x O.D. 25mm
27116	M22 x 1.5 nut, , O.D. 27mm
27216	M22 x 1.5 nut* 1/8" o-ring
27116-30	3.0 - 2.5mm sealed nut, O.D. 27mm
27116-40	4.0 - 3.5mm sealed nut, O.D. 27mm
27116-45	4.5 - 4.0mm sealed nut, O.D. 27mm
27116-50	5.0 - 4.5mm sealed nut, O.D. 27mm
27116-55	5.5 - 5mm sealed nut, O.D. 27mm
27116-60	6.0 - 5.5mm sealed nut, O.D. 27mm
27116-65	6.5 - 6mm sealed nut, O.D. 27mm
DNA16W	DNA 16 collet wrench
DNA16TWA	DNA 16 torque wrench adapter
894-22	DNA 16 mini nut wrench

DNA 20 Dead Nuts Accurate Collets

Part No.	Shank Size inch/mm	Range inch/mm
1120.0300	2.5 - 3mm	.098" - .118" / .5mm
1120.0350	1/8" / 3 - 3.5mm	.118" - .138" / .5mm
1120.0400	5/32" / 3.5 - 4mm	.137" - .157" / .5mm
1120.0500	3/16" / 4 - 5mm	.157" - .197" / 1.0mm
1120.0600	7/32" 5 - 6mm	.197" - .236" / 1.0mm
1120.0018	exact size collet: 1/8"	.105" - .125" / .5mm
1120.0316	exact size collet: 3/16"	.147" - .187" / 1.0mm
1120.0014	exact size collet: 1/4"	.210" - .250" / 1.0mm
1120.0038	exact size collet: 3/8"	.335" - .375" / 1.0mm
2020.0000	DNA 20 nut, M25 x 1.5" x O.D. 32mm	
2020.0000C	DNA 20 coolant nut, uses ER 20 rings on page 52	
DNA20W	DNA 20 collet wrench	
DNA20TWA	DNA 20 torque wrench adapter	

DNA 32 Dead Nuts Accurate Collets

Part No.	Shank Size inch/mm	Range inch/mm
1132.0300	2.5 - 3mm	.098" - .118" / .5mm
1132.0350	1/8" / 3 - 3.5mm	.118" - .138" / .5mm
1132.0400	5/32" / 3.5 - 4mm	.137" - .157" / .5mm
1132.0500	3/16" / 4 - 5mm	.157" - .197" / 1.0mm
1132.0600	7/32" 5 - 6mm	.197" - .236" / 1.0mm
1132.0018	exact size collet: 1/8"	.105" - .125" / .5mm
1132.0316	exact size collet: 3/16"	.147" - .187" / 1.0mm
1132.0014	exact size collet: 1/4"	.210" - .250" / 1.0mm
1132.0038	exact size collet: 3/8"	.335" - .375" / 1.0mm
1132.0000	DNA 32 nut, M40 x 1.5" x O.D. 47.5mm	
1132.0000C	DNA 32 coolant nut, uses ER 25 rings on page 52	
DNA32W	DNA 32 collet wrench	
DNA32TWA	DNA 32 torque wrench adapter	

Steel Sealed Precision ER Coolant Collets – Inch Size



Features

- Sealed to 2000 PSI
- No plugs
- Protects tool holder from contaminants
- Use with standard ER Power Coat nuts (page 50)

Designed for use with on-size tools.

Use with ER, RD, DR, ESX or BR collet chucks.



ER Inch Size Collet Sets

Part No.	Size	Pcs.	Fits Shank Sizes
04543IS	ER 16	10	3/32 - 3/8"
04544IS	ER 20	12	5/32 - 1/2"
04545IS	ER 25	14	7/32 - 5/8"
04546IS	ER 32	18	7/32 - 3/4"
04547IS	ER 40	15	3/8 - 1.0"

ER 16 Inch Size

Part No.	Shank
04543-3/32	3/32"
04543-1/8	1/8"
04543-5/32	5/32"
04543-3/16	3/16"
04543-7/32	7/32"
04543-1/4	1/4"
04543-9/32	9/32"
04543-5/16	5/16"
04543-11/32	11/32"
04543-3/8	3/8"
04543-13/32	13/32"

ER 20 Inch Size

Part No.	Shank
04544-5/32	5/32"
04544-3/16	3/16"
04544-7/32	7/32"
04544-1/4	1/4"
04544-9/32	9/32"
04544-5/16	5/16"
04544-11/32	11/32"
04544-3/8	3/8"
04544-13/32	13/32"
04544-7/16	7/16"
04544-15/32	15/32"
04544-1/2	1/2"

ER 25 Inch Size

Part No.	Shank
04545-7/32	7/32"
04545-1/4	1/4"
04545-9/32	9/32"
04545-5/16	5/16"
04545-11/32	11/32"
04545-3/8	3/8"
04545-13/32	13/32"
04545-7/16	7/16"
04545-15/32	15/32"
04545-1/2	1/2"
04545-17/32	17/32"
04545-9/16	9/16"
04545-19/32	19/32"
04545-5/8	5/8"

ER 32 Inch Size

Part No.	Shank
04546-7/32	7/32"
04546-1/4	1/4"
04546-9/32	9/32"
04546-5/16	5/16"
04546-11/32	11/32"
04546-3/8	3/8"
04546-13/32	13/32"
04546-7/16	7/16"
04546-15/32	15/32"
04546-1/2	1/2"
04546-17/32	17/32"
04546-9/16	9/16"
04546-19/32	19/32"
04546-5/8	5/8"
04546-21/32	21/32"
04546-11/16	11/16"
04546-23/32	23/32"
04546-3/4	3/4"

ER 40 Inch Size

Part No.	Shank
04547-3/8	3/8"
04547-13/32	13/32"
04547-7/16	7/16"
04547-15/32	15/32"
04547-1/2	1/2"
04547-17/32	17/32"
04547-9/16	9/16"
04547-19/32	19/32"
04547-5/8	5/8"
04547-21/32	21/32"
04547-11/16	11/16"
04547-23/32	23/32"
04547-3/4	3/4"
04547-7/8	7/8"
04547-1	1.0"

Steel Sealed Precision ER Coolant Collets – Metric Size



Features

- Sealed to 2000 PSI
- No plugs
- Protects tool holder from contaminants
- Use with standard ER Power Coat nuts (page 50)

Designed for use with on-size tools.

Use with ER, RD, DR, ESX or BR collet chucks.



ER Metric Size Collet Sets

Part No.	Size	Pcs.	Fits Shank Sizes
04543MS	ER 16	8	3 - 10mm
04544MS	ER 20	11	3 - 13mm
04545MS	ER 25	14	3 - 16mm
04546MS	ER 32	18	3 - 20mm

ER 16 Metric Size

Part No.	Shank
04543-03	3mm
04543-04	4mm
04543-05	5mm
04543-06	6mm
04543-07	7mm
04543-08	8mm
04543-09	9mm
04543-10	10mm

ER 20 Metric Size

Part No.	Shank
04544-03	3mm
04544-04	4mm
04544-05	5mm
04544-06	6mm
04544-07	7mm
04544-08	8mm
04544-09	9mm
04544-10	10mm
04544-11	11mm
04544-12	12mm
04544-13	13mm

ER 25 Metric Size

Part No.	Shank
04545-03	3mm
04545-04	4mm
04545-05	5mm
04545-06	6mm
04545-07	7mm
04545-08	8mm
04545-09	9mm
04545-10	10mm
04545-11	11mm
04545-12	12mm
04545-13	13mm
04545-14	14mm
04545-15	15mm
04545-16	16mm

ER 32 Metric Size

Part No.	Shank
04546-03	3mm
04546-04	4mm
04546-05	5mm
04546-06	6mm
04546-07	7mm
04546-08	8mm
04546-09	9mm
04546-10	10mm
04546-11	11mm
04546-12	12mm
04546-13	13mm
04546-14	14mm
04546-15	15mm
04546-16	16mm
04546-17	17mm
04546-18	18mm
04546-19	19mm
04546-20	20mm

ER 40 Metric Size

Part No.	Shank
04547-06	6mm
04547-08	8mm
04547-10	10mm
04547-11	11mm
04547-12	12mm
04547-13	13mm
04547-14	14mm
04547-16	16mm
04547-18	18mm
04547-20	20mm
04547-25	25mm

Precision ER Sealed Coolant Collets



Features

- Larger plugs for 750 PSI coolant
- Use with standard ER Power Coat nuts (page 50)
- Exclusive design reduces points of failure 50%

Use with ER, RD, DR, ESX or BR collet chucks.

ER 16 Sealed Collets

Part No.	Shank
08316-03.0	3mm
08316-03.5	3.5mm
08316-04.0	4mm
08316-04.5	4.5mm
08316-05.0	5mm
08316-05.5	5.5mm
08316-06.0	6mm
08316-1/4	1/4"
08316-06.5	6.5mm
08316-07.0	7mm
08316-07.5	7.5mm
08316-08.0	8mm
08316-08.5	8.5mm
08316-09.0	9mm
08316-09.5	9.5mm
08316-10.0	10mm

ER 20 Sealed Collets

Part No.	Shank
08320-03.0	3mm
08320-03.5	3.5mm
08320-04.0	4mm
08320-04.5	4.5mm
08320-05.0	5mm
08320-05.5	5.5mm
08320-06.0	6mm
08320-1/4	1/4"
08320-06.5	6.5mm
08320-07.0	7mm
08320-07.5	7.5mm
08320-08.0	8mm
08320-08.5	8.5mm
08320-09.0	9mm
08320-09.5	9.5mm
08320-10.0	10mm
08320-10.5	10.5mm
08320-11.0	11mm
08320-11.5	11.5mm
08320-12.0	12mm
08320-12.5	12.5mm
08320-1/2	1/2"
08320-13.0	13mm

Sealed Collet Sets

Part No.	Description
08316MS	15 pcs. ER 16
08320MS	21 pcs ER 20
08325MS	27 pcs ER 25
08332-35MS	35 pcs ER 32
08340-41MS	41 pcs ER 40

ER 25 Sealed Collets

Part No.	Shank
08325-03.0	3mm
08325-03.5	3.5mm
08325-04.0	4mm
08325-04.5	4.5mm
08325-05.0	5mm
08325-05.5	5.5mm
08325-06.0	6mm
08325-1/4	1/4"
08325-06.5	6.5mm
08325-07.0	7mm
08325-07.5	7.5mm
08325-08.0	8mm
08325-08.5	8.5mm
08325-09.0	9mm
08325-09.5	9.5mm
08325-10.0	10mm
08325-10.5	10.5mm
08325-11.0	11mm
08325-11.5	11.5mm
08325-12.0	12mm
08325-12.5	12.5mm
08325-1/2	1/2"
08325-13.0	13mm
08325-13.5	13.5mm
08325-14.0	14mm
08325-14.5	14.5mm
08325-15.0	15mm
08325-15.5	15.5mm
08325-16.0	16mm

ER 32 Sealed Collets

Part No.	Shank
08332-03.0	3mm
08332-03.5	3.5mm
08332-04.0	4mm
08332-04.5	4.5mm
08332-05.0	5mm
08332-05.5	5.5mm
08332-06.0	6mm
08332-1/4	1/4"
08332-06.5	6.5mm
08332-07.0	7mm
08332-07.5	7.5mm
08332-08.0	8mm
08332-08.5	8.5mm
08332-09.0	9mm
08332-09.5	9.5mm
08332-10.0	10mm
08332-10.5	10.5mm
08332-11.0	11mm
08332-11.5	11.5mm
08332-12.0	12mm
08332-12.5	12.5mm
08332-1/2	1/2"
08332-13.0	13mm
08332-13.5	13.5mm
08332-14.0	14mm
08332-14.5	14.5mm
08332-15.0	15mm
08332-15.5	15.5mm
08332-16.0	16mm
08332-16.5	16.5mm
08332-17.0	17mm
08332-17.5	17.5mm
08332-18.0	18mm
08332-18.5	18.5mm
08332-19	19mm
08332-3/4	3/4"
08332-19.5	19.5mm
08332-20.0	20mm

ER 40 Sealed Collets

Part No.	Shank
08340-06.0	6mm
08340-1/4	1/4"
08340-06.5	6.5mm
08340-07.0	7mm
08340-07.5	7.5mm
08340-08.0	8mm
08340-08.5	8.5mm
08340-09.0	9mm
08340-09.5	9.5mm
08340-10.0	10mm
08340-10.5	10.5mm
08340-11.0	11mm
08340-11.5	11.5mm
08340-12.0	12mm
08340-12.5	12.5mm
08340-1/2	1/2"
08340-13.0	13mm
08340-13.5	13.5mm
08340-14.0	14mm
08340-14.5	14.5mm
08340-15.0	15mm
08340-15.5	15.5mm
08340-16.0	16mm
08340-16.5	16.5mm
08340-17.0	17mm
08340-17.5	17.5mm
08340-18.0	18mm
08340-18.5	18.5mm
08340-19.0	19mm
08340-3/4	3/4"
08340-19.5	19.5mm
08340-20.0	20mm
08340-20.5	20.5mm
08340-21.0	21mm
08340-21.5	21.5mm
08340-22.0	22mm
08340-22.5	22.5mm
08340-23.0	23mm
08340-23.5	23.5mm
08340-24.0	24mm
08340-24.5	24.5mm
08340-25.0	25mm
08340-25.5	25.5mm
08340-26.0	26mm

Precision ER Floating Tap Collets and Collet Sets



Features

- Axial compensation prevents breaking taps
- Replaces expensive tapping heads
- Locking feature prevents spinning the tap
- Reduce tapping clearance requirements

Compatible with these standard collet chucks:
ER, DR, RD, ESX, BR or DIN 6499 collet pockets.

Applications: CNC lathes, VDI turrets, angle heads, CNC machine center, swiss style turning machines, and driven heads on CNC lathe turrets.

Simply program the machine 5% behind the recommended pitch feed of the tap to make the floating collet work. Return out of the tapped hole at 100%.

For best performance use FT tap collets with Techniks Power Coat nut. See page 50.

FT Collet Sets

Part No.	Description
FT-1164IS	4 piece collet set
FT-1205IS	5 piece collet set
FT-1259IS	9 piece collet set
FT-13211IS	11 piece collet set

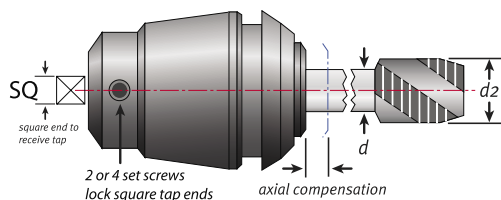

FT-116 Floating Tap Collets

Part No.	d	SQ	Tap Size (d2)
FT-116-141	.141"	.110"	1/8" or #6
FT-116-168	.168"	.131"	5/32" or #8
FT-116-194	.194"	.152"	3/16" or #10
FT-116-220	.220"	.165"	7/32" or #12

axial compensation = 7mm

FT-120 Floating Tap Collets

Part No.	d	SQ	Tap Size (d2)
FT-120-141	.141"	.110"	1/8" or #6
FT-120-168	.168"	.131"	5/32" or #8
FT-120-194	.194"	.152"	3/16" or #10
F	.220"	.165"	7/32" or #12
F	.255"	.191"	1/4"

axial compensation = 7mm

FT-125 Floating Tap Collets

Part No.	d	SQ	Tap Size (d2)
FT-125-141	.141"	.110"	1/8" or #6
FT-125-168	.168"	.131"	5/32" or #8
FT-125-194	.194"	.152"	3/16" or #10
FT-125-220	.220"	.165"	7/32" or #12
FT-125-255	.255"	.191"	1/4"
FT-125-318	.318"	.238"	5/16"
FT-125-323	.323"	.242"	7/16"
FT-125-367	.367"	.275"	1/2"
FT-125-381	.381"	.286"	3/8"

axial compensation = 8mm

FT-132 Floating Tap Collets

Part No.	d	SQ	Tap Size (d2)
FT-132-168	.168"	.131"	5/32" or #8
FT-132-194	.194"	.152"	3/16" or #10
FT-132-220	.220"	.165"	7/32" or #12
FT-132-255	.255"	.191"	1/4"
FT-132-318	.318"	.238"	5/16"
FT-132-323	.323"	.242"	7/16"
FT-132-367	.367"	.275"	1/2"
FT-132-381	.381"	.286"	3/8"
FT-132-429	.429"	.322"	9/16"
FT-132-437	.437"	.328"	1/8" NPT
FT-132-480	.480"	.360"	5/8"

axial compensation = 10mm

Precision ER Rigid Tap Collets



Features

- Replaces expensive tap holders
- Reduce tapping clearance requirements
- Metric sizes available upon request
- Special design locks square in slots

Compatible with ER, DR, RD, ESX, BR or DIN 6499 collet pockets.

For best results use with a Power Coat nut to increase clamping pressure up to 75%. See page 50.

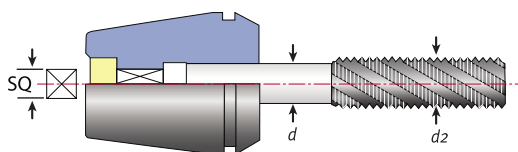

Rigid Tap Collet Sets

Part No.	Description
05320-5(SET)	5 piece ER 16 set
05320-9(SET)	9 piece ER 16 set
05410-9(SET)	9 piece ER 20 set
05510-11(SET)	11 piece ER 25 set
05570-16(SET)	16 piece ER 32 set
05710-21(SET)	21 piece ER 40 set

ER 16 Rigid Tap Collets

Part No.	d	SQ	Tap Size (d2)
05320-141	.141"	.110"	1/8" or #6
05320-168	.168"	.131"	5/32" or #8
05320-194	.194"	.152"	3/16" or #10
05320-220	.220"	.165"	7/32" or #12
05320-255	.255"	.191"	1/4"
05320-318	.318"	.238"	5/16"
05320-323	.323"	.242"	7/16"
05320-367	.367"	.275"	1/2"
05320-381	.381"	.286"	3/8"

ER 20 Rigid Tap Collets

Part No.	d	SQ	Tap Size (d2)
05410-141	.141"	.110"	1/8" or #6
05410-168	.168"	.131"	5/32" or #8
05410-194	.194"	.152"	3/16" or #10
05410-220	.220"	.165"	7/32" or #12
05410-255	.255"	.191"	1/4"
05410-318	.318"	.238"	5/16"
05410-323	.323"	.242"	7/16"
05410-367	.367"	.275"	1/2"
05410-381	.381"	.286"	3/8"

ER 25 Rigid Tap Collets

Part No.	d	SQ	Tap Size (d2)
05510-141	.141"	.110"	1/8" or #6
05510-168	.168"	.131"	5/32" or #8
05510-194	.194"	.152"	3/16" or #10
05510-220	.220"	.165"	7/32" or #12
05510-255	.255"	.191"	1/4"
05510-318	.318"	.238"	5/16"
05510-323	.323"	.242"	7/16"
05510-367	.367"	.275"	1/2"
05510-381	.381"	.286"	3/8"
05510-429	.429"	.322"	9/16"
05510-437	.437"	.328"	1/8" NPT
05510-480	.480"	.360"	5/8"

ER 32 Rigid Tap Collets

Part No.	d	SQ	Tap Size (d2)
05570-141	.141"	.110"	1/8" or #6
05570-168	.168"	.131"	5/32" or #8
05570-194	.194"	.152"	3/16" or #10
05570-220	.220"	.165"	7/32" or #12
05570-255	.255"	.191"	1/4"
05570-318	.318"	.238"	5/16"
05570-323	.323"	.242"	7/16"
05570-367	.367"	.275"	1/2"
05570-381	.381"	.286"	3/8"
05570-429	.429"	.322"	9/16"
05570-437	.437"	.328"	1/8" NPT
05570-480	.480"	.360"	5/8"
05570-542	.542"	.406"	11/16"
05570-562	.562"	.421"	1/4" NPT
05570-590	.590"	.442"	3/4"
05570-652	.652"	.489"	13/16"

ER 40 Rigid Tap Collets

Part No.	d	SQ	Tap Size (d2)
05710-141	.141"	.110"	1/8" or #6
05710-168	.168"	.131"	5/32" or #8
05710-194	.194"	.152"	3/16" or #10
05710-220	.220"	.165"	7/32" or #12
05710-255	.255"	.191"	1/4"
05710-318	.318"	.238"	5/16"
05710-323	.323"	.242"	7/16"
05710-367	.367"	.275"	1/2"
05710-381	.381"	.286"	3/8"
05710-429	.429"	.322"	9/16"
05710-437	.437"	.328"	1/8" NPT
05710-480	.480"	.360"	5/8"
05710-542	.542"	.406"	11/16"
05710-562	.562"	.421"	1/4" NPT
05710-590	.590"	.442"	3/4"
05710-652	.652"	.489"	13/16"
05710-687	.687"	.515"	1/2" NPT
05710-697	.697"	.523"	7/8"
05710-700	.700"	.531"	3/8" NPT
05710-760	.760"	.570"	15/16"
05710-800	.800"	.600"	1"

Precision ER Quick-Change Rigid Tap Collets



Features

- Quick-Change taps in seconds
- Replaces expensive tap holders
- Locking feature prevents spinning the tap
- Reduce tapping clearance requirements

Compatible with these standard collet chucks:
ER, DR, RD, ESX, BR or DIN 6499 collet pockets.

For best tapping performance use with Techniks Power Coat nut for highest holding power and accuracy. See page 50.

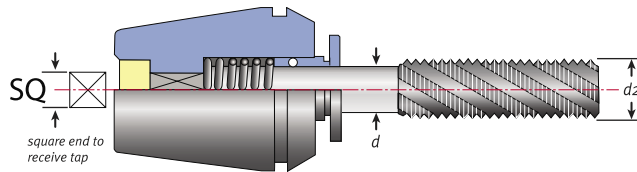

Quick-Change Tap Collet Sets

Part No.	Description
05802-SET	4 piece collet set
05804-8(SET)	8 piece collet set
05806-SET	11 piece collet set
05808-15(SET)	15 piece collet set

ER 16 Quick-Change Rigid Tap

Part No.	d	SQ	Tap Size (d2)
05802-168	.168"	.131"	5/32" or #8
05802-194	.194"	.152"	3/16" or #10
05802-220	.220"	.165"	7/32" or #12
05802-255	.255"	.191"	1/4"

ER 20 Quick-Change Rigid Tap

Part No.	d	SQ	Tap Size (d2)
05804-168	.168"	.131"	5/32" or #8
05804-194	.194"	.152"	3/16" or #10
05804-220	.220"	.165"	7/32" or #12
05804-255	.255"	.191"	1/4"
05804-318	.318"	.238"	5/16"
05804-323	.323"	.242"	7/16"
05804-367	.367"	.275"	1/2"
05804-381	.381"	.286"	3/8"

ER 25 Quick-Change Rigid Tap

Part No.	d	SQ	Tap Size (d2)
05806-168	.168"	.131"	5/32" or #8
05806-194	.194"	.152"	3/16" or #10
05806-220	.220"	.165"	7/32" or #12
05806-255	.255"	.191"	1/4"
05806-318	.318"	.238"	5/16"
05806-323	.323"	.242"	7/16"
05806-367	.367"	.275"	1/2"
05806-381	.381"	.286"	3/8"
05806-429	.429"	.322"	9/16"
05806-437	.437"	.328"	1/8" NPT
05806-480	.480"	.360"	5/8"

ER 32 Quick-Change Rigid Tap

Part No.	d	SQ	Tap Size (d2)
05808-168	.168"	.131"	5/32" or #8
05808-194	.194"	.152"	3/16" or #10
05808-220	.220"	.165"	7/32" or #12
05808-255	.255"	.191"	1/4"
05808-318	.318"	.238"	5/16"
05808-323	.323"	.242"	7/16"
05808-367	.367"	.275"	1/2"
05808-381	.381"	.286"	3/8"
05808-429	.429"	.322"	9/16"
05808-437	.437"	.328"	1/8" NPT
05808-480	.480"	.360"	5/8"
05808-542	.542"	.406"	11/16"
05808-562	.562"	.421"	1/4" NPT
05808-590	.590"	.442"	3/4"
05808-652	.652"	.489"	13/16"



Distributors - Call to register for our Distributors Webstore for full online access.

Power Coat ER Collet Nuts and Coolant Nuts



Features

- Increases holding power by 75%
- Balanced to 25,000 RPM
- Better rigidity and T.I.R. (runout)

Power Coat Standard ER Collet Nuts

Part No.	Description	D	B	T	Wrench
41111	ER 11 Power Coat hex nut	19mm	12mm	M14 x 0.75	04608
41116	ER 16 Power Coat hex nut	27.5mm	18mm	M22 x 1.5	04609
41120	ER 20 Power Coat hex nut	34mm	19mm	M25 x 1.5	04610
41916	ER 16 Power Coat slot nut	32mm	18mm	M22 x 1.5	04613
41920	ER 20 Power Coat slot nut	35mm	19.5mm	M25 x 1.5	04614
41925	ER 25 Power Coat slot nut	42mm	21mm	M32 x 1.5	04615
41932	ER 32 Power Coat slot nut	50mm	23mm	M40 x 1.5	04616
41940	ER 40 Power Coat slot nut	63mm	26mm	M50 x 1.5	04617
41950	ER 50 Power Coat slot nut	78mm	35mm	M64 x 2.0	04618

Power Coat Ultra High-Speed ER Nuts (balanced up to 70,000 RPM)

Part No.	Description	D	B	T	Wrench
46111	ER 11 high speed hex nut	19mm	11.8mm	M14 x 0.75	04608
46116	ER 16 high speed slot nut	27.5mm	18.0mm	M22 x 1.5	04613
46120	ER 20 high speed slot nut	35mm	19.5mm	M25 x 1.5	04614
46125	ER 25 high speed slot nut	42mm	20.5mm	M32 x 1.5	04615
46132	ER 32 high speed slot nut	50mm	23.0mm	M40 x 1.5	04616
46140	ER 40 high speed slot nut	63mm	26.0mm	M50 x 1.5	04617



Features

- Increases holding power by 75%
- Seals up to 1,500 P.S.I.
- Balanced to 25,000 RPM
- Use with coolant rings pg. 52

Power Coat ER Coolant Nuts

Part No.	Description	D	B	T	Wrench
41616	ER 16 coolant slot nut	32	22.5	M22x1.5	04613
41620	ER 20 coolant slot nut	35	24	M25x1.5	04614
41625	ER 25 coolant slot nut	42	25	M32x1.5	04615
41632	ER 32 coolant slot nut	50	27.5	M40x1.5	04616
41640	ER 40 coolant slot nut	63	30.7	M50x1.5	04617

Holding Power Testing – ft/lbs

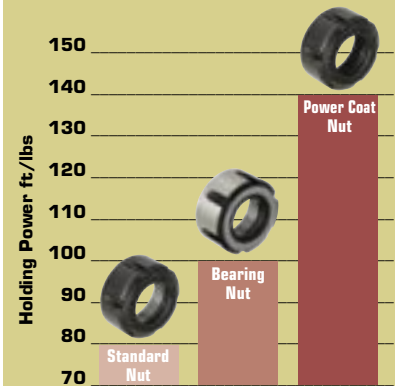

Each nut was tightened to 70 ft/lbs recommended torque before break-free testing of holding power.

Watch the Holding Power testing video at:

www.technikususa.com/pcnut

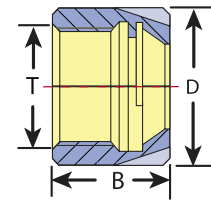

For best performance use a torque wrench and tighten nut to proper torque specification. Snap collet into nut before assembly.

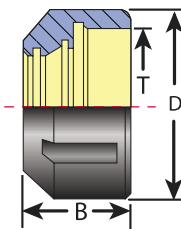

Coolant ring snaps into the nut to seal the tool shank. (pg. 52)
For coolant-thru tools.

Power Coat ER Bearing Nuts and ER Mini Nuts



Features

- Increases holding power by 75%
- Balanced to 18,000 RPMs
- Snap collet into nut before assembly

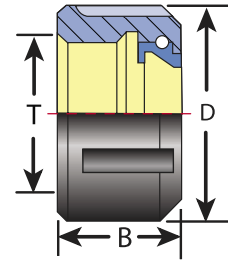

Power Coat Bearing Nuts

Part No.	Description	D	B	T	Wrench
29116	ER 16 high speed bearing nut	27.5mm	18mm	M22x1.5	04609
29132	ER 32 high speed bearing nut	50mm	25mm	M40x1.5	04616

Note: Use a torque wrench and tighten nut to proper torque specification. Do not over tighten these nuts. Snap collet into nut before assembly.



ER Mini Nut

Features

- For minimum nose O.D. applications
- Increases holding power by 75%
- High speed nuts balanced to 20,000 RPM

ER High Speed Mini Nuts (balanced to 20,000 RPM at G2.5)

Part No.	Description	D	B	T	Wrench
33108	ER 8 high speed mini nut	12mm	11mm	M10 x 0.75	04620
33111	ER 11 high speed mini nut	16mm	12mm	M13 x 0.75	04621
33116	ER 16 high speed mini nut	22mm	18mm	M19 x 1.0	04622
33120	ER 20 high speed mini nut	28mm	19.5mm	M24 x 1.0	04623
33125	ER 25 high speed mini nut	35mm	21mm	M30 x 1.0	04624
33125-L	ER 25 h.s. left-hand mini nut	35mm	21mm	M30 x 1.0	04624

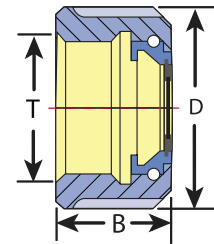

ER Standard Mini Nuts (balanced to 10,000 RPM at G2.5)

Part No.	Description	D	B	T	Wrench
23108	ER 8 standard mini nut	12mm	11mm	M10 x 0.75	04620
23111	ER 11 standard mini nut	16mm	12mm	M13 x 0.75	04621
23116	ER 16 standard mini nut	22mm	18mm	M19 x 1.0	04622
23120	ER 20 standard mini nut	28mm	19.5mm	M24 x 1.0	04623
23125	ER 25 standard mini nut	35mm	21mm	M30 x 1.0	04624

ER Mini Coolant Nuts (balanced to 10,000 RPM at G2.5)

Part No.	Description	Ring	D	B	T	Wrench
23616	ER 16 mini coolant nut	ER 16	22mm	24mm	M19 x 1.0	04622
23620	ER 20 mini coolant nut	ER 20	28mm	24mm	M24 x 1.0	04623
23625	ER 25 mini coolant nut	ER 25	35mm	26.5mm	M30 x 1.0	04624



Coolant Style Mini nut uses ER coolant rings (page 52)

ER Coolant Rings



Snap ring into nut before ER collet

Features

- Seals up to 1,500 P.S.I.
- Use with standard ER collets
- Use with Power Coat coolant nuts



Power Coat coolant nuts pg. 50

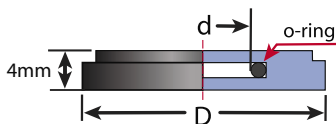

NOTE: Remove o-ring for coolant surround tool applications using standard non-coolant cutting tools. (see photos pg. 53)

ER 16 Coolant Rings

Part No.	Shank mm	Shank inch
08516-03.5	3.5 – 3.0mm	1/8"
08516-04.0	4.0 – 3.5mm	5/32"
08516-04.5	4.5 – 4.0mm	11/64"
08516-05.0	5.0 – 4.5mm	3/16"
08516-05.5	5.5 – 5.0mm	13/64"
08516-06.0	6.0 – 5.5mm	7/32"
08516-06.5	6.5 – 6.0mm	1/4"
08516-07.0	7.0 – 6.5mm	17/64"
08516-07.5	7.5 – 7.0mm	9/32"
08516-08.0	8.0 – 7.5mm	5/16"
08516-08.5	8.5 – 8.0mm	21/64"
08516-09.0	9.0 – 8.5mm	11/32"
08516-09.5	9.5 – 9.0mm	3/8"
08516-10.0	10.0 – 9.5mm	25/64"

ER 20 Coolant Rings

Part No.	Shank mm	Shank inch
08520-03.5	3.5 – 3.0mm	1/8"
08520-04.0	4.0 – 3.5mm	5/32"
08520-04.5	4.5 – 4.0mm	11/64"
08520-05.0	5.0 – 4.5mm	3/16"
08520-05.5	5.5 – 5.0mm	13/64"
08520-06.0	6.0 – 5.5mm	7/32"
08520-06.5	6.5 – 6.0mm	1/4"
08520-07.0	7.0 – 6.5mm	17/64"
08520-07.5	7.5 – 7.0mm	9/32"
08520-08.0	8.0 – 7.5mm	5/16"
08520-08.5	8.5 – 8.0mm	21/64"
08520-09.0	9.0 – 8.5mm	11/32"
08520-09.5	9.5 – 9.0mm	3/8"
08520-10.0	10.0 – 9.5mm	25/64"
08520-10.5	10.5 – 10.0mm	13/32"
08520-11.0	11.0 – 10.5mm	27/64"
08520-11.5	11.5 – 11.0mm	7/16"
08520-12.0	12.0 – 11.5mm	15/32"
08520-12.5	12.5 – 12.0mm	31/64"
08520-13.0	13.0 – 12.5mm	1/2"

Dimensions

	D
ER 16	12.9 mm
ER 20	15.9 mm
ER 25	21 mm
ER 32	26.95 mm
ER 40	33.3 mm

ER 25 Coolant Rings

Part No.	Shank mm	Shank inch
08525-03.5	3.5 – 3.0mm	1/8"
08525-04.0	4.0 – 3.5mm	5/32"
08525-04.5	4.5 – 4.0mm	11/64"
08525-05.0	5.0 – 4.5mm	3/16"
08525-05.5	5.5 – 5.0mm	13/64"
08525-06.0	6.0 – 5.5mm	7/32"
08525-06.5	6.5 – 6.0mm	1/4"
08525-07.0	7.0 – 6.5mm	17/64"
08525-07.5	7.5 – 7.0mm	9/32"
08525-08.0	8.0 – 7.5mm	5/16"
08525-08.5	8.5 – 8.0mm	21/64"
08525-09.0	9.0 – 8.5mm	11/32"
08525-09.5	9.5 – 9.0mm	3/8"
08525-10.0	10.0 – 9.5mm	25/64"
08525-10.5	10.5 – 10.0mm	13/32"
08525-11.0	11.0 – 10.5mm	27/64"
08525-11.5	11.5 – 11.0mm	7/16"
08525-12.0	12.0 – 11.5mm	15/32"
08525-12.5	12.5 – 12.0mm	31/64"
08525-13.0	13.0 – 12.5mm	1/2"
08525-13.5	13.5 – 13.0mm	17/32"
08525-14.0	14.0 – 13.5mm	35/64"
08525-14.5	14.5 – 14.0mm	9/16"
08525-15.0	15.0 – 14.5mm	37/64"
08525-15.5	15.5 – 15.0mm	19/32"
08525-16.0	16.0 – 15.5mm	5/8"

ER 32 Coolant Rings

Part No.	Shank mm	Shank inch
08532-03.5	3.5 – 3.0mm	1/8"
08532-04.0	4.0 – 3.5mm	5/32"
08532-04.5	4.5 – 4.0mm	11/64"
08532-05.0	5.0 – 4.5mm	3/16"
08532-05.5	5.5 – 5.0mm	13/64"
08532-06.0	6.0 – 5.5mm	7/32"
08532-06.5	6.5 – 6.0mm	1/4"
08532-07.0	7.0 – 6.5mm	17/64"
08532-07.5	7.5 – 7.0mm	9/32"
08532-08.0	8.0 – 7.5mm	5/16"
08532-08.5	8.5 – 8.0mm	21/64"
08532-09.0	9.0 – 8.5mm	11/32"
08532-09.5	9.5 – 9.0mm	3/8"
08532-10.0	10.0 – 9.5mm	25/64"
08532-10.5	10.5 – 10.0mm	13/32"
08532-11.0	11.0 – 10.5mm	27/64"
08532-11.5	11.5 – 11.0mm	7/16"
08532-12.0	12.0 – 11.5mm	15/32"
08532-12.5	12.5 – 12.0mm	31/64"
08532-13.0	13.0 – 12.5mm	1/2"
08532-13.5	13.5 – 13.0mm	17/32"
08532-14.0	14.0 – 13.5mm	35/64"
08532-14.5	14.5 – 14.0mm	9/16"
08532-15.0	15.0 – 14.5mm	37/64"
08532-15.5	15.5 – 15.0mm	19/32"
08532-16.0	16.0 – 15.5mm	5/8"
08532-16.5	16.5 – 16.0mm	41/64"
08532-17.0	17.0 – 16.5mm	21/32"
08532-17.5	17.5 – 17.0mm	11/16"
08532-18.0	18.0 – 17.5mm	45/64"
08532-18.5	18.5 – 18.0mm	23/32"
08532-19.0	19.0 – 18.5mm	3/4"
08532-19.5	19.5 – 19.0mm	49/64"
08532-20.0	20.0 – 19.5mm	25/32"

ER Coolant Rings



Use ER Coolant Rings without "o" ring for coolant surround tool application.

Cost Study Over 4 Year Period

Figures based on 20 toolholders, allowing 4 collets a year for each toolholder for a total of 320 collets, plus one nut for each toolholder over the four year period.

	ER 32 Coolant Collet	ER 32 Coolant Ring System
Cost of 320 collets	\$16,000.00	\$8,640.00
Cost of 20 nuts	\$ 0.00 (come with holders)	\$1,300.00 (includes rings)
Total 4 year cost	\$16,000.00	\$9,940.00
		\$6,060.00 savings

ER 40 Coolant Rings

Part No.	Shank mm	Shank inch
08540-03.5	3.5 - 3.0mm	1/8"
08540-04.0	4.0 - 3.5mm	5/32"
08540-04.5	4.5 - 4.0mm	11/64"
08540-05.0	5.0 - 4.5mm	3/16"
08540-05.5	5.5 - 5.0mm	13/64"
08540-06.0	6.0 - 5.5mm	7/32"
08540-06.5	6.5 - 6.0mm	1/4"
08540-07.0	7.0 - 6.5mm	17/64"
08540-07.5	7.5 - 7.0mm	9/32"
08540-08.0	8.0 - 7.5mm	5/16"
08540-08.5	8.5 - 8.0mm	21/64"
08540-09.0	9.0 - 8.5mm	11/32"
08540-09.5	9.5 - 9.0mm	3/8"
08540-10.0	10.0 - 9.5mm	25/64"
08540-10.5	10.5 - 10.0mm	13/32"

Part No.	Shank mm	Shank inch
08540-11.0	11.0 - 10.5mm	27/64"
08540-11.5	11.5 - 11.0mm	7/16"
08540-12.0	12.0 - 11.5mm	15/32"
08540-12.5	12.5 - 12.0mm	31/64"
08540-13.0	13.0 - 12.5mm	1/2"
08540-13.5	13.5 - 13.0mm	17/32"
08540-14.0	14.0 - 13.5mm	35/64"
08540-14.5	14.5 - 14.0mm	9/16"
08540-15.0	15.0 - 14.5mm	37/64"
08540-15.5	15.5 - 15.0mm	19/32"
08540-16.0	16.0 - 15.5mm	5/8"
08540-16.5	16.5 - 16.0mm	41/64"
08540-17.0	17.0 - 16.5mm	21/32"
08540-17.5	17.5 - 17.0mm	11/16"
08540-18.0	18.0 - 17.5mm	45/64"
08540-18.5	18.5 - 18.0mm	23/32"



Use ER Coolant Rings with "o" ring for coolant thru tool.

ER coolant rings are great for unattended operation - there are no rubber seals to blow out under high pressure.

ER Coolant Ring Sets

Part No.	Description
08516-14(SET)	14 piece ER 16 coolant ring set
08520-20(SET)	20 piece ER 20 coolant ring set
08525-26(SET)	26 piece ER 25 coolant ring set
08532-34(SET)	34 piece ER 32 coolant ring set
08540-46(SET)	46 piece ER 40 coolant ring set

Part No.	Shank mm	Shank inch
08540-19.0	19.0 - 18.5mm	3/4"
08540-19.5	19.5 - 19.0mm	49/64"
08540-20.0	20.0 - 19.5mm	25/32"
08540-20.5	20.5 - 20.0mm	51/64"
08540-21.0	21.0 - 20.5mm	13/16"
08540-21.5	21.5 - 21.0mm	27/32"
08540-22.0	22.0 - 21.5mm	55/64"
08540-22.5	22.5 - 22.0mm	7/8"
08540-23.0	23.0 - 22.5mm	29/32"
08540-23.5	23.5 - 23.0mm	59/64"
08540-24.0	24.0 - 23.5mm	15/16"
08540-24.5	24.5 - 24.0mm	61/64"
08540-25.0	25.0 - 24.5mm	31/32"
08540-25.5	25.5 - 25.0mm	1.0"
08540-26.0	26.0 - 25.5mm	1 1/64"

Precision TG 75 Collets and Power Coat Nut



Features

- .0004" T.I.R.
- Precision ground & hand inspected
- Clamping range: 1/64"



Dimensions

Series	L	A
TG 75	1.844"	1.062"

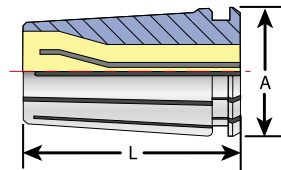

TG 75 Sets

Part No.	Pieces	ID Sizes
04008-43S	43	1/8" - 3/4" by 64 ^{ths}
04008-22S	22	1/8" - 3/4" by 32 ^{nds}
04008-11S	11	1/8" - 3/4" by 16 ^{ths}

TG 75 Collets

Part No.	Shank	Part No.	Shank	Part No.	Shank	Part No.	Shank
04008-3/32	3/32"	04008-17/64	17/64"	04008-7/16	7/16"	04008-39/64	39/64"
04008-7/64	7/64"	04008-9/32	9/32"	04008-29/64	29/64"	04008-5/8	5/8"
04008-1/8	1/8"	04008-19/64	19/64"	04008-15/32	15/32"	04008-41/64	41/64"
04008-9/64	9/64"	04008-5/16	5/16"	04008-31/64	31/64"	04008-21/32	21/32"
04008-5/32	5/32"	04008-21/64	21/64"	04008-1/2	1/2"	04008-43/64	43/64"
04008-11/64	11/64"	04008-11/32	11/32"	04008-33/64	33/64"	04008-11/16	11/16"
04008-3/16	3/16"	04008-23/64	23/64"	04008-17/32	17/32"	04008-45/64	45/64"
04008-13/64	13/64"	04008-3/8	3/8"	04008-35/64	35/64"	04008-23/32	23/32"
04008-7/32	7/32"	04008-25/64	25/64"	04008-9/16	9/16"	04008-47/64	47/64"
04008-15/64	15/64"	04008-13/32	13/32"	04008-37/64	37/64"	04008-3/4	3/4"
04008-1/4	1/4"	04008-27/64	27/64"	04008-19/32	19/32"		



Features

- Increases holding power by 75%
- Balanced to 25,000 RPM
- Better rigidity and less T.I.R. (runout)

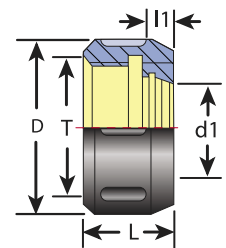

TG 75 Power Coat Collet Nut

Part No.	Description	D	d1	T	l1	L	Wrench	Torque
27500	TG75 Collet Nut	1.88"	-	1 1/2 - 12"	0.32"	0.94"	04018	85 ft/lb

Precision TG 100 Collets and Power Coat Nut



Features

- .0004" T.I.R.
- Precision ground & hand inspected
- Clamping range: 1/64"



Dimensions

Series	L	A
TG 100	2.375"	1.379"

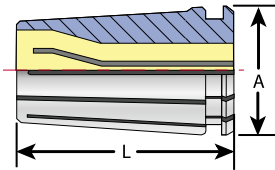

TG 100 Sets

Part No.	Pcs.	ID Sizes
04010-59S	59	3/32 - 1" by 64 ^{ths}
04010-41S	41	3/8 - 1" by 64 ^{ths}
04010-30S	30	3/32 - 1" by 32 ^{nds}
04010-21S	21	3/8 - 1" by 32 ^{nds}
04010-15S	15	1/8 - 1" by 16 ^{ths}

TG 100 Collets

Part No.	Shank	Part No.	Shank	Part No.	Shank	Part No.	Shank
04010-3/32	3/32"	04010-21/64	21/64"	04010-9/16	9/16"	04010-51/64	51/64"
04010-7/64	7/64"	04010-11/32	11/32"	04010-37/64	37/64"	04010-13/16	13/16"
04010-1/8	1/8"	04010-23/64	23/64"	04010-19/32	19/32"	04010-53/64	53/64"
04010-9/64	9/64"	04010-3/8	3/8"	04010-39/64	39/64"	04010-27/32	27/32"
04010-5/32	5/32"	04010-25/64	25/64"	04010-5/8	5/8"	04010-55/64	55/64"
04010-11/64	11/64"	04010-13/32	13/32"	04010-41/64	41/64"	04010-7/8	7/8"
04010-3/16	3/16"	04010-27/64	27/64"	04010-21/32	21/32"	04010-57/64	57/64"
04010-13/64	13/64"	04010-7/16	7/16"	04010-43/64	43/64"	04010-29/32	29/32"
04010-7/32	7/32"	04010-29/64	29/64"	04010-11/16	11/16"	04010-59/64	59/64"
04010-15/64	15/64"	04010-15/32	15/32"	04010-45/64	45/64"	04010-15/16	15/16"
04010-1/4	1/4"	04010-31/64	31/64"	04010-23/32	23/32"	04010-61/64	61/64"
04010-17/64	17/64"	04010-1/2	1/2"	04010-47/64	47/64"	04010-31/32	31/32"
04010-9/32	9/32"	04010-33/64	33/64"	04010-3/4	3/4"	04010-63/64	63/64"
04010-19/64	19/64"	04010-17/32	17/32"	04010-49/64	49/64"	04010-1	1.0"
04010-5/16	5/16"	04010-35/64	35/64"	04010-25/32	25/32"		



Features

- Increases holding power by 75%
- Balanced to 25,000 RPM
- Better rigidity and less T.I.R. (runout) increase cutting tool life

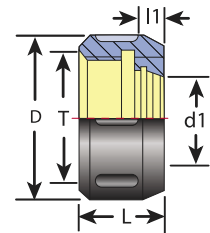

TG 100 Power Coat Nuts

Part No.	Description	D	d1	T	l1	L	Spanner	Torque
28110	TG 100 Collet Nut	2.35"	1.12"	1 7/8 - 12"	0.44"	1.18"	03691	85 ft/lb



Distributors - Call to register for our Distributors Webstore for full online access.

Precision TG 100 Coolant Collets and Power Coat Nut



Features

- Up to 750 PSI coolant
- .0004" T.I.R.
- Clamping range: 1/64"

Use with TG Power Coat Nut pg. 55.



Dimensions

Series	L	A
TG 100	2.375"	1.379"

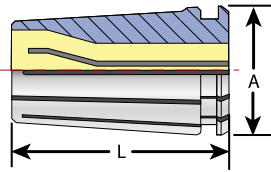

TG 100 Coolant Collet Sets

Part No.	Pcs.	ID Sizes
84063-(SET)	25	1/4" - 1.0" by 64 ^{ths}

TG 100 Coolant Collets

Part No.	Shank	Part No.	Shank	Part No.	Shank	Part No.	Shank Size
84063-1/4	1/4"	84063-7/16	7/16"	84063-5/8	5/8"	84063-13/16	13/16"
84063-9/32	9/32"	84063-15/32	15/32"	84063-21/32	21/32"	84063-27/32	27/32"
84063-5/16	5/16"	84063-1/2	1/2"	84063-11/16	11/16"	84063-7/8	7/8"
84063-11/32	11/32"	84063-17/32	17/32"	84063-23/32	23/32"	84063-29/32	29/32"
84063-3/8	3/8"	84063-9/16	9/16"	84063-3/4	3/4"	84063-15/16	15/16"
84063-13/32	13/32"	84063-19/32	19/32"	84063-25/32	25/32"	84063-31/32	31/32"
						84063-1	1.0"



Use with ER coolant rings page 51.

Features

- Works with standard TG 100 collets
- Up to 1,500 PSI coolant
- Increases holding power by 75%



ER 32 coolant ring snaps into the nut to seal the tool shank.

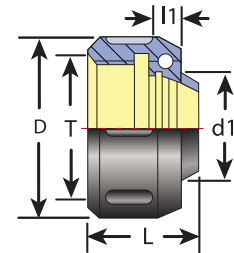

TG 100 Coolant Nuts

Part No.	Description	D	d1	T	l1	L	Spanner	Torque
28210	TG 100 Coolant Nut	2.35"	0.95"	1 7/8 - 12"	0.44"	1.41"	03691	85 ft/lb

Precision TG 150 Collets and Collet Sets



Features

- .0004" T.I.R.
- Precision ground & hand inspected
- Clamping range: 1/64"



Dimensions

Series	L	A
TG 150	3.0"	2.001"

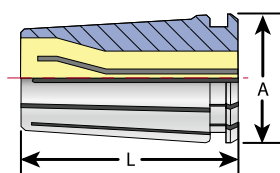

TG 150 Sets

Part No.	Pcs.	ID Sizes
04011-65S	65	1/2 - 1 1/2" by 64 ^{ths}
04011-33S	33	1/2 - 1 1/2" by 32 ^{nds}
04011-17S	17	1/2 - 1 1/2" by 16 ^{ths}

TG 150 Collets

Part No.	Shank	Part No.	Shank	Part No.	Shank	Part No.	Shank
04011-1/2	1/2"	04011-49/64	49/64"	04011-1.1/32	1-1/32"	04011-1.19/64	1-19/64"
04011-33/64	33/64"	04011-25/32	25/32"	04011-1.3/64	1-3/64"	04011-1.5/16	1-5/16"
04011-17/32	17/32"	04011-51/64	51/64"	04011-1.1/16	1-1/16"	04011-1.21/64	1-21/64"
04011-35/64	35/64"	04011-13/16	13/16"	04011-1.5/64	1-5/64"	04011-1.11/32	1-11/32"
04011-9/16	9/16"	04011-53/64	53/64"	04011-1.3/32	1-3/32"	04011-1.23/64	1-23/64"
04011-37/64	37/64"	04011-27/32	27/32"	04011-1.7/64	1-7/64"	04011-1.3/8	1-3/8"
04011-19/32	19/32"	04011-55/64	55/64"	04011-1.1/8	1-1/8"	04011-1.25/64	1-25/64"
04011-39/64	39/64"	04011-7/8	7/8"	04011-1.9/64	1-9/64"	04011-1.13/32	1-13/32"
04011-5/8	5/8"	04011-57/64	57/64"	04011-1.5/32	1-5/32"	04011-1.27/64	1-27/64"
04011-41/64	41/64"	04011-29/32	29/32"	04011-1.11/64	1-11/64"	04011-1.7/16	1-7/16"
04011-21/32	21/32"	04011-59/64	59/64"	04011-1.3/16	1-3/16"	04011-1.29/64	1-29/64"
04011-43/64	43/64"	04011-15/16	15/16"	04011-1.13/64	1-13/64"	04011-1.15/32	1-15/32"
04011-11/16	11/16"	04011-61/64	61/64"	04011-1.7/32	1-7/32"	04011-1.31/64	1-31/64"
04011-45/64	45/64"	04011-31/32	31/32"	04011-1.15/64	1-15/64"	04011-1.1/2	1-1/2"
04011-23/32	23/32"	04011-63/64	63/64"	04011-1.1/4	1-1/4"		
04011-47/64	47/64"	04011-1	1.0"	04011-1.17/64	1-17/64"		
04011-3/4	3/4"	04011-1.1/64	1-1/64"	04011-1.9/32	1-9/32"		

SYOZ / EOC (DIN 6388) Perske Style Collets and Nuts



Features

- T.I.R. (runout) .0004"
- Collapse range: 1/64"
- Made from high-carbon steel

These collets and collet nuts conform to DIN 6388 standards. Snap collet into the nut before screwing the nut on to the spindle or holder.

SYOZ 25 Collet Set

Part No.	Description
03868-11(SET)	11 pcs. SYOZ 25

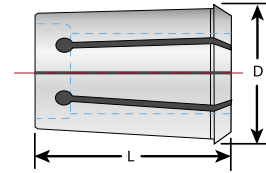

SYOZ 20 Collets

Part No.	Shank Size
03520-1/8	1/8"
03520-3/16	3/16"
03520-1/4	1/4"
03520-5/16	5/16"
03520-3/8	3/8"
03520-7/16	7/16"
03520-1/2	1/2"
03520-10	10mm

SYOZ 25 Collets

Part No.	Shank Size
03868-1/8	1/8"
03868-3/16	3/16"
03868-1/4	1/4"
03868-5/16	5/16"
03868-3/8	3/8"
03868-7/16	7/16"
03868-1/2	1/2"
03868-9/16	9/16"
03868-5/8	5/8"
03868-3/4	3/4"
03868-7/8	7/8"
03868-1	1.0"
03868-10	10mm
03868-16	16mm
03868-20	20mm
03868-25	25mm

SYOC / EOC Collet Dimensions

Part No.	L	D
SYOZ 20	34mm	20mm
SYOZ 25	52mm	35mm
EOC o8	26mm	14.4mm
EOC 16	40mm	25.5mm



DIN 6388 Nuts and Wrenches

Part No.	Description	L	D	Wrench
03508-NUT	EOC o8 nut	19	30	-
03636-NUT	EOC 16 nut	24	43	03636
03520-NUT	SYOZ 20/EOC 12 nut	20	35	22220
03520-L	SYOZ 20/EOC 12 left-hand nut	20	35	22220
83632-NUT	SYOZ 25 bearing nut	30	60	03691

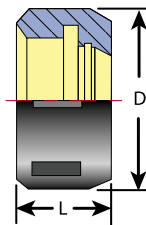

EOC 8 Collets

Part No.	Shank Size
03508-1/8	1/8"
03508-3/16	3/16"
03508-1/4	1/4"
03508-5/16	5/16"

EOC 16 Collets

Part No.	Shank Size
03531-1/8	1/8"
03531-3/16	3/16"
03531-1/4	1/4"
03531-5/16	5/16"
03531-3/8	3/8"
03531-7/16	7/16"
03531-1/2	1/2"
03531-9/16	9/16"
03531-5/8	5/8"
03531-10	10mm
03531-16	16mm

Precision Double Angle (DA) Collets



Features

- Collapse range: 1/64"
- Made from high-carbon steel

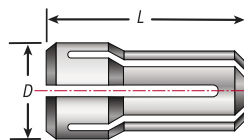

Double Angle Collet Sets

DA 180	Description
01618-9S	9pc 1/4 - 3/4" by 16 ^{ths}
01618-17S	17pc 1/4 - 3/4" by 32 ^{nds}
01618-21S	21pc 1/8 - 3/4" by 32 ^{nds}
01618-33S	33pc 1/4 - 3/4" by 64 ^{ths}
01618-41S	41pc 1/8 - 3/4" by 64 ^{ths}

DA 100	Description
01610-8S	8pc 1/8 - 9/16" by 16 ^{ths}
01610-15S	15pc 1/8 - 9/16" by 32 ^{nds}
01610-21S	21pc 1/4 - 9/16" by 64 ^{ths}
01610-29S	29pc 1/8 - 9/16" by 64 ^{ths}
01610-33S	33pc 1/16 - 9/16" by 64 ^{ths}

DA 200	Description
01620-9S	9pc 1/8 - 3/8" by 32 ^{nds}
01620-17S	17pc 1/8 - 3/8" by 64 ^{ths}
01620-21S	21pc 1/16 - 3/8" by 64 ^{ths}

Dimensions

Series	L	D
DA 180	1.625"	1.035"
DA 100	1.438"	0.769"
DA 200	1.188"	0.531"
DA 300	1.000"	0.375"

DA 300	Description
01630-7S	7pc 1/16 - 1/4" by 32 ^{nds}
01630-14S	14pc 3/64 - 1/4" by 64 ^{ths}

The last number in the part number indicates the number of collets in the set.

DA 180 Collets	Size
01618-1/16	1/16"
01618-5/64	5/64"
01618-3/32	3/32"
01618-7/64	7/64"
01618-1/8	1/8"
01618-9/64	9/64"
01618-5/32	5/32"
01618-11/64	11/64"
01618-3/16	3/16"
01618-13/64	13/64"
01618-7/32	7/32"
01618-15/64	15/64"
01618-1/4	1/4"
01618-17/64	17/64"
01618-9/32	9/32"
01618-19/64	19/64"
01618-5/16	5/16"
01618-21/64	21/64"
01618-11/32	11/32"
01618-23/64	23/64"
01618-3/8	3/8"
01618-25/64	25/64"
01618-13/32	13/32"
01618-27/64	27/64"
01618-7/16	7/16"
01618-29/64	29/64"
01618-15/32	15/32"
01618-31/64	31/64"
01618-1/2	1/2"
01618-33/64	33/64"

DA 180 Collets	Size
01618-17/32	17/32"
01618-35/64	35/64"
01618-9/16	9/16"
01618-37/64	37/64"
01618-19/32	19/32"
01618-39/64	39/64"
01618-5/8	5/8"
01618-41/64	41/64"
01618-21/32	21/32"
01618-43/64	43/64"
01618-11/16	11/16"
01618-45/64	45/64"
01618-23/32	23/32"
01618-47/64	47/64"
01618-3/4	3/4"

DA 100 Collets	Size
01610-1/16	1/16"
01610-5/64	5/64"
01610-3/32	3/32"
01610-7/64	7/64"
01610-1/8	1/8"
01610-9/64	9/64"
01610-5/32	5/32"
01610-11/64	11/64"
01610-3/16	3/16"
01610-13/64	13/64"
01610-7/32	7/32"
01610-15/64	15/64"
01610-1/4	1/4"

DA 100 Collets	Size
01610-17/64	17/64"
01610-9/32	9/32"
01610-19/64	19/64"
01610-5/16	5/16"
01610-21/64	21/64"
01610-11/32	11/32"
01610-23/64	23/64"
01610-3/8	3/8"
01610-25/64	25/64"
01610-13/32	13/32"
01610-27/64	27/64"
01610-7/16	7/16"
01610-29/64	29/64"
01610-15/32	15/32"
01610-31/64	31/64"
01610-1/2	1/2"
01610-33/64	33/64"
01610-17/32	17/32"
01610-35/64	35/64"
01610-9/16	9/16"

DA 200 Collets	Size
01620-3/64	3/64"
01620-1/16	1/16"
01620-5/64	5/64"
01620-3/32	3/32"
01620-7/64	7/64"
01620-1/8	1/8"
01620-9/64	9/64"
01620-5/32	5/32"

DA 200 Collets	Size
01620-11/64	11/64"
01620-3/16	3/16"
01620-13/64	13/64"
01620-7/32	7/32"
01620-15/64	15/64"
01620-1/4	1/4"
01620-17/64	17/64"
01620-9/32	9/32"
01620-19/64	19/64"
01620-5/16	5/16"
01620-21/64	21/64"
01620-11/32	11/32"
01620-23/64	23/64"
01620-3/8	3/8"

DA 300 Collets	Size
01630-3/64	3/64"
01630-1/16	1/16"
01630-5/64	5/64"
01630-3/32	3/32"
01630-7/64	7/64"
01630-1/8	1/8"
01630-9/64	9/64"
01630-5/32	5/32"
01630-11/64	11/64"
01630-3/16	3/16"
01630-13/64	13/64"
01630-7/32	7/32"
01630-15/64	15/64"
01630-1/4	1/4"



Sign up to receive special offers at: www.techniksusa.com/contact.htm

CNC Collet Identification and Special Orders Guide

Use the guide below for selecting replacement collets. The best way to tell what type of collet you have is to measure the length of the collet. ER, TG, and SYOZ collets all have unique measurements. For best results always use a Power Coat nut tightened to proper specification using an accurate torque wrench.

ER Collet	L	D	Torque Spec
ER 8	13mm (.51")	8.5mm (.33")	-
ER 11	18mm (.708")	11.5mm (.45")	17 ft/lbs
ER 16	27.5mm (1.08")	17mm (.67")	43 ft/lbs
ER 20	31.5mm (1.24")	21mm (.83")	64 ft/lbs
ER 25	34mm (1.34")	26mm (1.02")	81 ft/lbs
ER 32	40mm (1.57")	33mm (1.3")	107 ft/lbs
ER 40	46mm (1.81")	41mm (1.61")	119 ft/lbs
ER 50	60 mm (2.36")	52mm (2.05")	-

TG Collet	L	D	Torque Spec
TG 75	47mm (1.85")	27mm (1.06")	85 ft/lbs
TG 100	60mm (2.36")	35mm (1.38")	85 ft/lbs
TG 150	76mm (3")	51mm (2")	-

SYOZ / EOC Collet	L	D
EOC 8	26mm (1.026")	14.4mm (.567")
SYOZ 20	34mm (1.34")	20mm (.78")
RDO 20	34mm (1.34")	20mm (.78")
407E	34mm (1.34")	20mm (.78")
EOC 12	34mm (1.34")	20mm (.78")
SYOZ 25	52mm (2.06")	35mm (1.38")
RDO 35	52mm (2.06")	35mm (1.38")
462E / SYOZ 25	52mm (2.06")	35mm (1.38")
EOC 32	60mm (2.36")	43.7mm (1.72")

DA Collet	L	D
DA 180	1.625"	1.035"
DA 100	1.438"	.769"
DA 200	1.188"	.531"
DA 300	1.000"	.375"

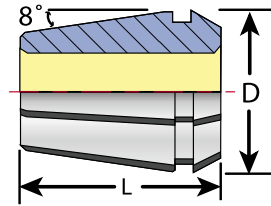

ER Collet Style

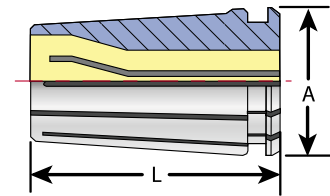

TG Collet Style

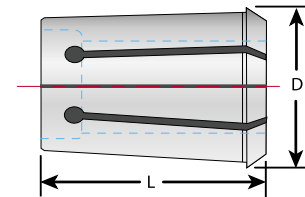

SYOZ Collet Style

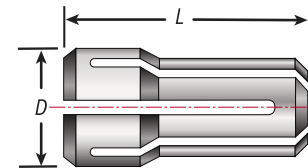

DA Collet Style

Special Order Collets Dimensions

Length _____ Diameter _____ Other Markings _____

Length _____ Diameter _____ Other Markings _____

Length _____ Diameter _____ Other Markings _____